

A map for friends of

LUPINEWOOD

1. Garage has a wood shop and a music studio located in the downstairs, and a private one-bedroom apartment upstairs. You're welcome to use the shop or studio, just text the community chat and ask for an orientation.

2. Public parking is where to park unless you're staying at Lupinewood.

3. Mailboxes

4. Carriage house is a three-bedroom house that we use for storage and that was gutted after mold problems made it uninhabitable.

5. Truth booth is a one-room structure with heat and electricity that we've used for therapy, meetings with clients, and hangouts.

This space can be reserved (see reverse).

6. Resident parking is for people staying or living at Lupinewood.

7. Wood shed is where we store garden tools.

8. Stone circle is a very nice place to sit.

9. Garden plots are available if there are things you want to grow.

10. Main house (see reverse)

11. Sauna (see opposing panel).

12. Compost is divided into a row of food compost piles and a row of bathroom compost piles. Each row has only one active pile, marked with a painted cinderblock. If you'd added food compost, dump a scoop of wood shavings on top, located in the trash can.

13. Maggie the Fagnolia tree.

14. Bus has heat and electricity that we've used for therapy, time alone, or hangouts. **This space can be reserved (see reverse).**

15. Hole that was a pool and will hopefully become first a venue for house shows and then an underground bathhouse. Watch out for poison ivy.

16. Pool house has a kitchen and public bathroom with a shower accessible from the outside rear door. We use it for many purposes. **This space can be reserved (see reverse).**

17. Lodge is used for ceremony.

18. Archery range is open to be used after an orientation and with special care (ask a collective member if you're interested).

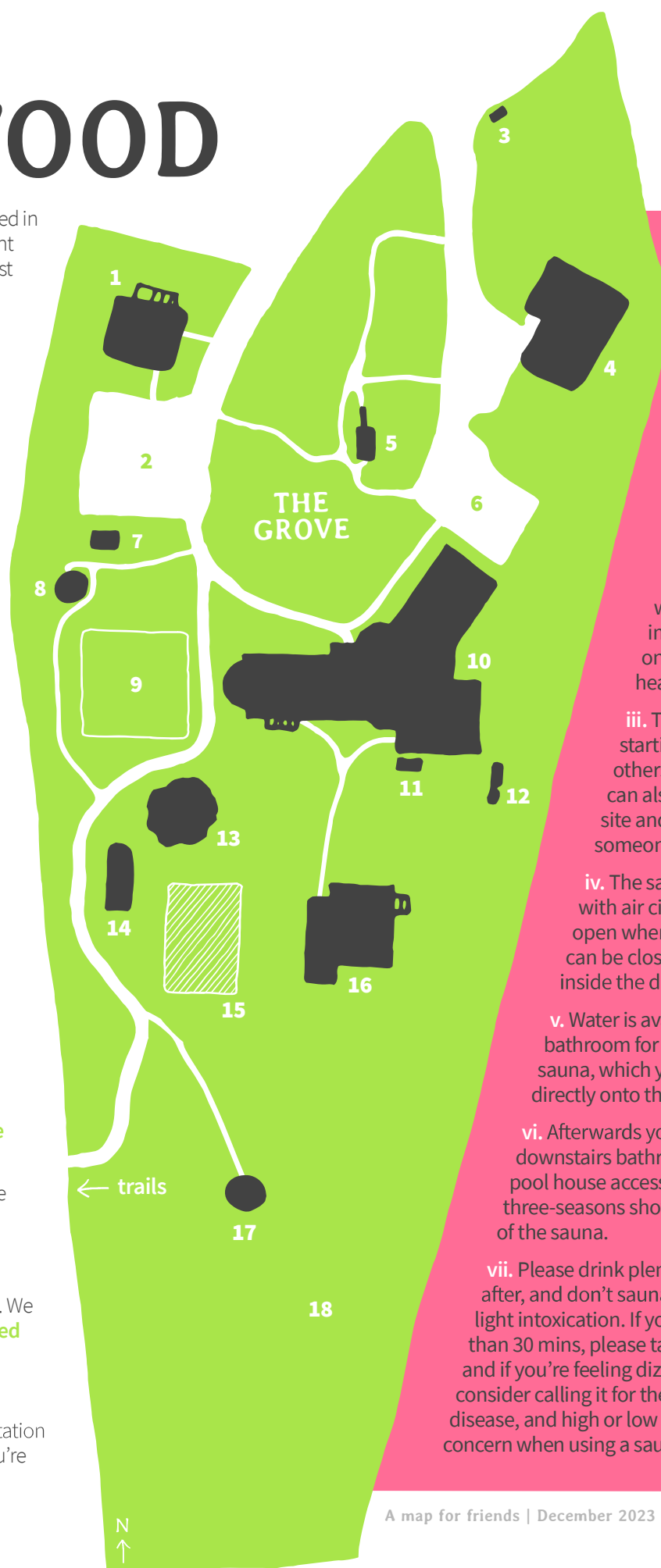

SAUNA USE

i. You can use the sauna any time of the day or night.

ii. The sauna takes roughly 30 mins to heat up and be ready for steam. To turn the sauna on, twist the knob on the left of the heater clockwise past the first click but before the second click. If you turn it past the second click the heater will start on a delay and won't immediately turn on. When it's on, the knob will be lit and you'll hear the heater humming.

iii. Text the community chat if you're starting or planning a sauna that others would be welcome to join. You can also text the chat if you're not on site and it would be helpful for someone to start the sauna for you.

iv. The sauna has two holes that help with air circulation: make sure they are open when people are inside. The holes can be closed for heating up the sauna just inside the door on the left.

v. Water is available from the downstairs bathroom for drinking and steam for the sauna, which you make by pouring water directly onto the stones on top of the heater.

vi. Afterwards you're welcome to use the downstairs bathroom shower, the shower in the pool house accessible from its back door, or the three-seasons shower that's mounted to the back of the sauna.

vii. Please drink plenty of water before, during, and after, and don't sauna under the effects of more than light intoxication. If you're going to sauna for more than 30 mins, please take a break in between sessions, and if you're feeling dizzy or sleepy, leave the sauna and consider calling it for the day. Pregnancy, diabetes, heart disease, and high or low blood pressure are all cause for concern when using a sauna.



THE MAIN HOUSE

f. Entryway g. Main stairs h. Foyer

i. **Downstairs bathroom** is the most public of the bathrooms and can be used for showering. There are clean towels folded and a place for them to hang when you're done. Please put your toilet paper in the bag next to the toilet.

j. **War / Octo room** houses the childcare program and its supplies and has a screen and gaming consoles. **This space can be reserved.**

k. **Nunnery** is used for storage and workout space.

l. **Studio** is where we run our online store and serves as the collective's office.

p. **Downstairs kitchen** is the main kitchen for the collective.

q. **Stone bathroom** is the new bathroom we added recently, and is usually reserved for use by long-term residents.

r. **Pantry** is where food is stored for the downstairs kitchen.

s. **Upstairs / Pink bathroom**

t. **Kitchenette** is a secondary and more private kitchen that the collective uses.

u. **Sun nook**

v. **Purple bathroom** is the only place at Lupinewood to take a bath currently.

Kids under the age of six need to be actively supervised.

Guests of yours are welcome in all the same spaces that you are as long as you are with them and can be responsible for them.

Dogs need to be on-leash and a heads-up texted to the community chat before they arrive. Once they've been appropriately introduced to resident pets at Lupinewood this can change.

We **lock the doors** at Lupinewood: ask a collective member to show you how it works, and what the current door code is.

Wood stoves can be interacted with only after you've been oriented by a collective member.

To reserve a space text the community chat and let folks know which room, when, and for what. Uses could include most anything, from private space for yourself, to meetings, seeing clients, or hosting your own friends.

a. **Laundry room** is located in the basement and is open for you to use from 5am to 11pm. Leave a donation behind in the jar to help cover the costs of others doing laundry. Remove lint from dryer before every use, and keep the area clean.

b. **Prow** is a great place for sunsets/storms.

c. **Stone porch** is where we have our freezers, store kindling for use in the unicorn room, and keep a big table for meetings, game nights, and so on.

d. **Goblin hole** sits under the stone porch and is accessible from the rounded doorway under the stairs. We use it for storage of mostly outdoors stuff.

e. **Unicorn / Warm room** has a projector where we watch movies, and one of the two wood stoves that largely heat the common areas in the house. We use it internally for meetings and the Letters For Release program. **This space can be reserved.**

m. **Apothecannery** is where we keep cleaning, canning, and medical supplies.

n. **Back hall** leads to the basement laundry room.

o. **Dining room** contains one of the large wood stoves that heats the main house and is used in connection with the next-door kitchen as a dining room.

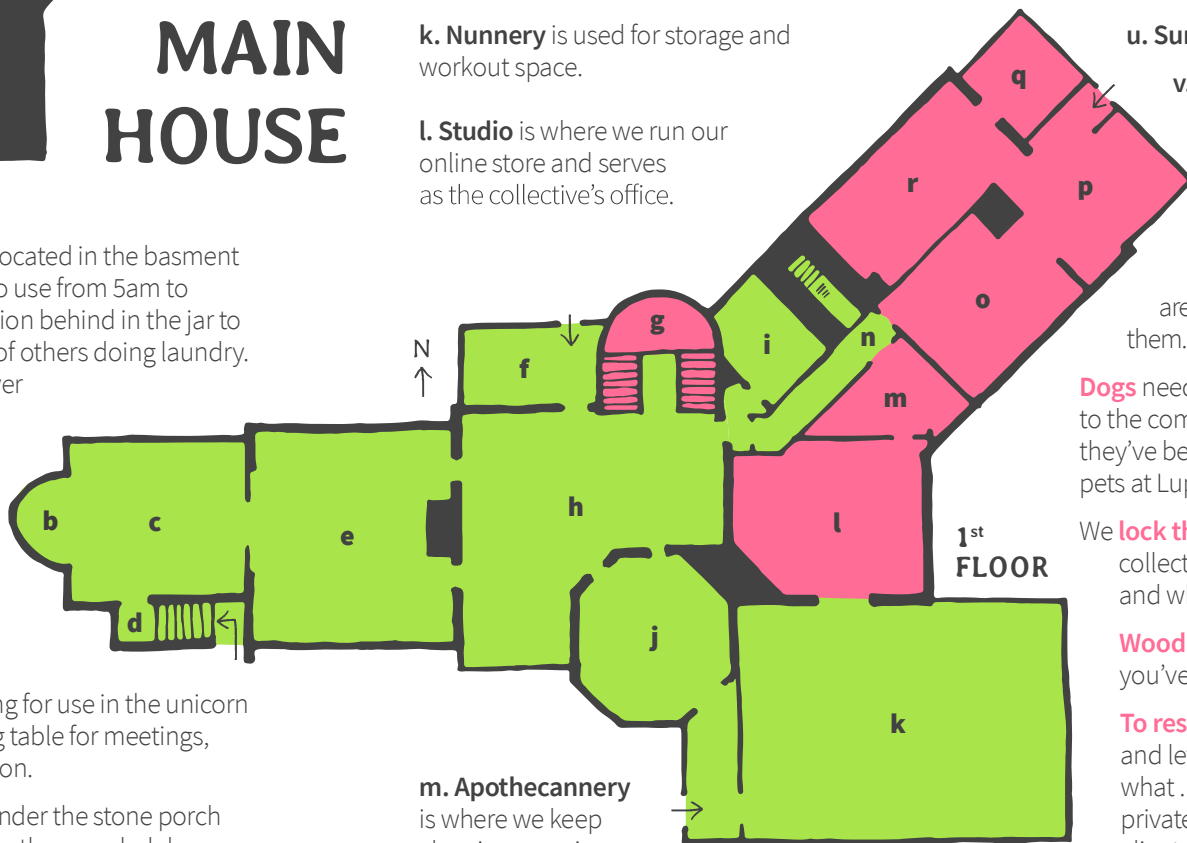

- Any time of the day or night—quiet hours from 10pm to 8am
- With a collective member or while working on a specific collective project
- Only when with a collective member

